



Middle Greeve

Wootton, Northampton

oriordanbond
SALES & LETTINGS



Middle Greeve

Wootton

NN4 6BB

PRICE £525,000

This well presented four bedroom detached family home is offered for sale in the sought after area of Wootton. The property occupies a larger than average plot and is conveniently positioned close to popular schools, amenities and transport links including good access to the M1 and A45.

The accommodation comprises entrance hall, cloakroom/WC, study, dual aspect sitting room, dining room with feature walk-in bay window, spacious kitchen and a utility room. To the first floor is a family bathroom and four bedrooms with the master benefitting from an en-suite shower room and dressing area. Outside is low maintenance frontage with driveway leading to a double garage with electric doors. The enclosed rear garden is larger than average and mainly laid to lawn screened by trees to the rear. Further benefits include gas radiator heating and double glazing. (B/1535/M)

Additional information

- Council Tax Band: F
- Energy Efficiency Rating: C

Viewing

Viewing strictly by appointment – details below

Disclaimer

O'Riordan Bond Estate Agents Limited has not tested apparatus, equipment, fittings or services and so cannot verify they are in working order. The buyer is advised to obtain verification from their solicitor or surveyor.

O'Riordan Bond Grange Park Sales
01604 432007

grangepark@oriordanbond.co.uk

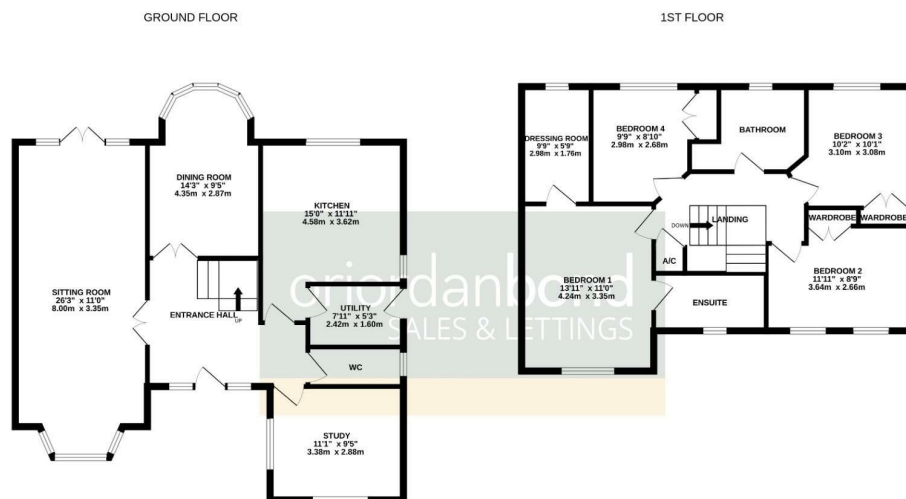

TOTAL FLOOR AREA: 1535 sq. ft. (142.6 sq.m.) approx.
Whilst every attempt has been made to ensure the accuracy of the floorplan contained here, measurements of doors, windows, rooms and any other items are approximate and no responsibility is taken for any error, omission or mis-statement. This plan is for illustrative purposes only and should be used as such by any prospective purchaser. The services, systems and appliances shown have not been tested and no guarantee as to their operability or efficiency can be given.
Made with Metrepx ©2025

